

Apex Ridge Heights

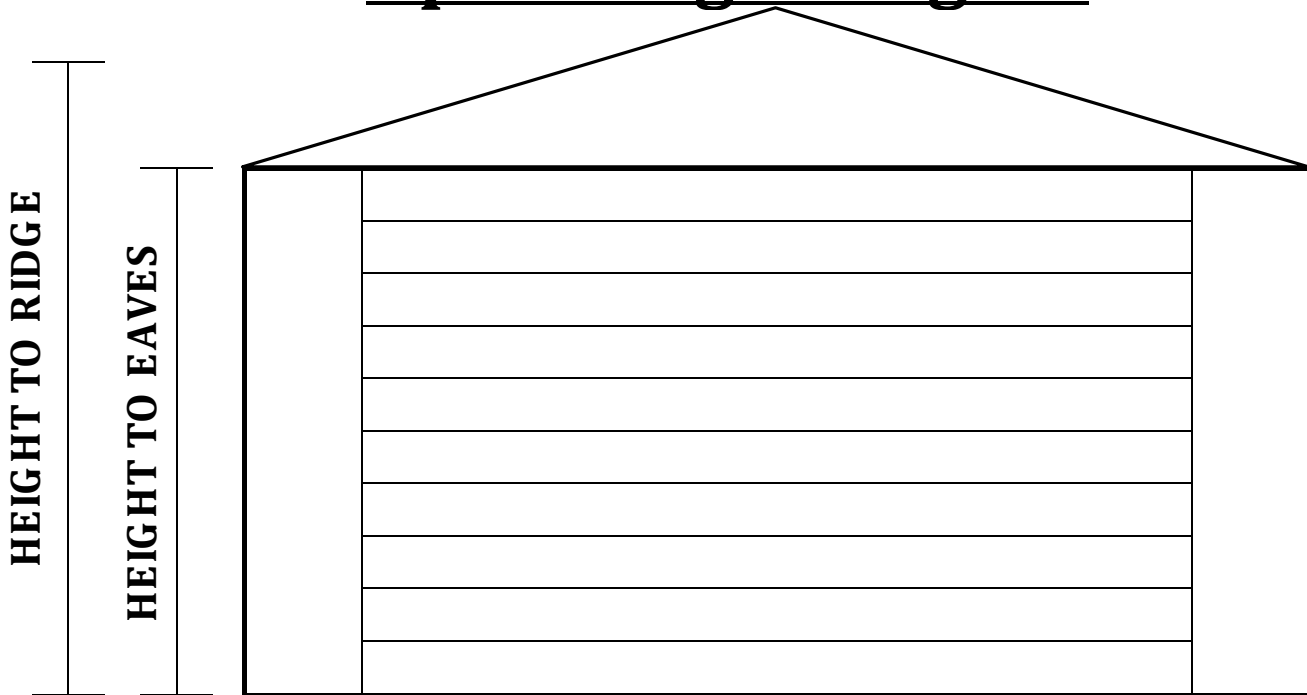

Width of Building	Fascia Height	Height to Ridge			
		6'6" Concrete		7'0" Concrete	
		No Roof	Cement Fibre	No Roof	Cement Fibre
8'3"	13¼" (33.7cm)	7'7¼"	7'9"	8'1¼"	8'3"
9'3"	14½" (36.2cm)	7'8½"	7'10¼"	8'2½"	8'4½"
10'3"	16" (40.7cm)	7'10"	7'11¾"	8'4"	8'5¾"
11'3"	16" (40.7cm)	7'10"	7'11¾"	8'4"	8'5¾"
12'3"	18¾" (47.6cm)	8'0¾"	8'2½"	8'6¾"	8'8½"
13'3"	18¾" (47.6cm)	8'0¾"	8'2½"	8'6¾"	8'8½"
14'3"	21" (53.3cm)	8'3"	8'4¾"	8'9"	8'10¾"
15'3"	21" (53.3cm)	8'3"	8'4¾"	8'9"	8'10¾"
16'3"	16½" (41.9cm)	7'10½"	8'0¼"	8'4½"	8'6¼"
17'3"	16½" (41.9cm)	7'10½"	8'0¼"	8'4½"	8'6¼"
18'3"	16½" (41.9cm)	7'10½"	8'0¼"	8'4½"	8'6¼"
19'3"	16½" (41.9cm)	7'10½"	8'0¼"	8'4½"	8'6¼"
20'3"	16½" (41.9cm)	7'10½"	8'0¼"	8'4½"	8'6¼"
21'3"	16½" (41.9cm)	7'10½"	8'0¼"	8'4½"	8'6¼"
22'3"	21½" (54.6cm)	8'3½"	8'5¼"	8'9½"	8'11¼"
23'3"	21½" (54.6cm)	8'3½"	8'5¼"	8'9½"	8'11¼"
24'3"	21½" (54.6cm)	8'3½"	8'5¼"	8'9½"	8'11¼"